

Flexo CA Coverplate EJs

Flexo CA: This floor joint system is a derivative-design of the widely used FxC. It employs composite centering-bar technology, and can be easily integrated (Butt-joined) with the FxC at changes in floor finish. FxCA offers less obtrusive visual presence than other systems. It is ideal for use in convention centres, department stores, corporate rooms and other floor spaces where carpet floor finish is used.

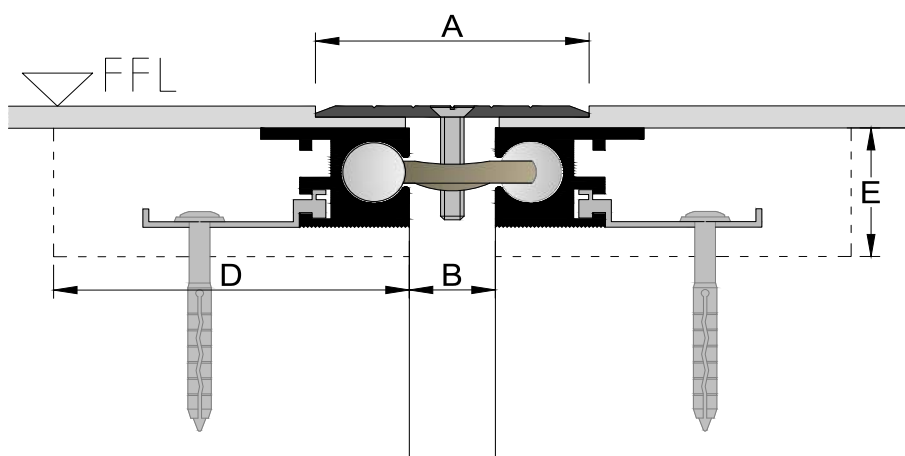
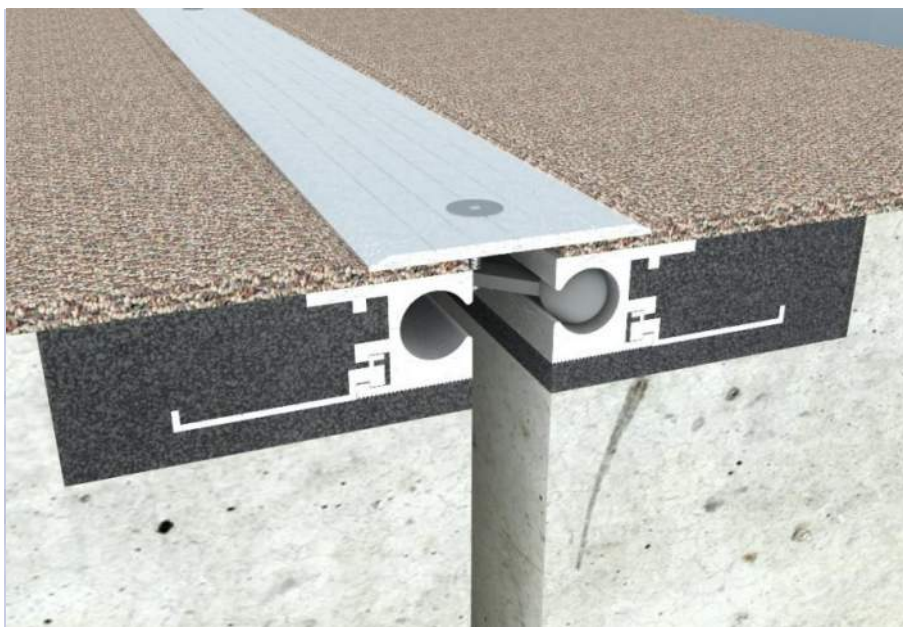

Product	A: Coverplate		B: Gap			
	Width	Thick	Min.	Mid.	Max.	Mvmt.
Fx50CA	50	3	6	29	52	46
Fx70CA	70	3	6	36	66	60
Fx100CA	100	4	6	51	96	90
Fx165CA	165	5	6	84	161	155

Fx CAS Stainless Steel Model Available

Block Out: 90D x 40E



Fx CA

Previous Model No: UACA



Performance

Concealed Fixings
Thermally Dynamic
High Capacity
Low Maintenance

Bead blasted cover plate
Slip resistance Class V
Tested to AS4586 2013

Compatible Finishes

Carpet

Standard Length

4.8m

Standard Finish

Anodised Aluminium

Options

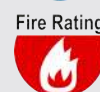

Disclaimer: All design rights reserved. Design and specifications are subject to change without notice. The manufacturer does not accept liability where the material on these pages is misconceived, exploited, or lacks conformity. The intention of this information is to provide a reasonable description of products, procedures and capabilities. Rev.6