

Flexo CH

Coverplate EJs

Flexo CH: A heavy duty architectural floor coverplate system designed for use with heavy pedestrian, and infrequent service-equipment traffic. Suitable for use in concourse areas such as stadiums, convention centres, airport terminals. FxCH can be supplied with coverplates finished in natural and colour anodised aluminium, or bead-blasted.

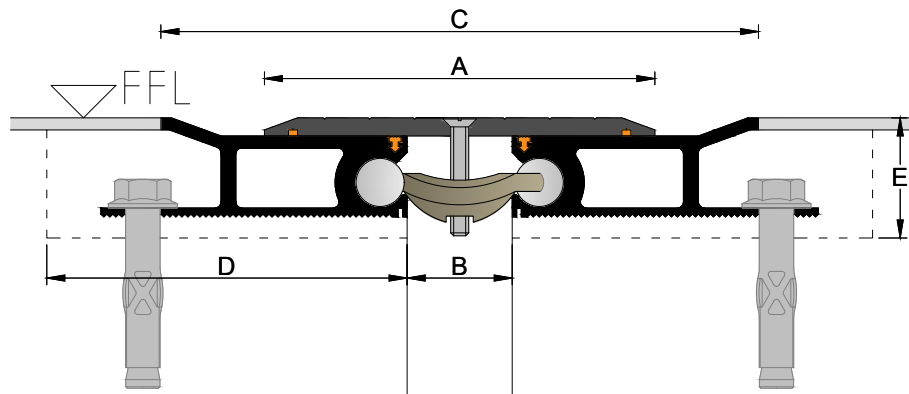
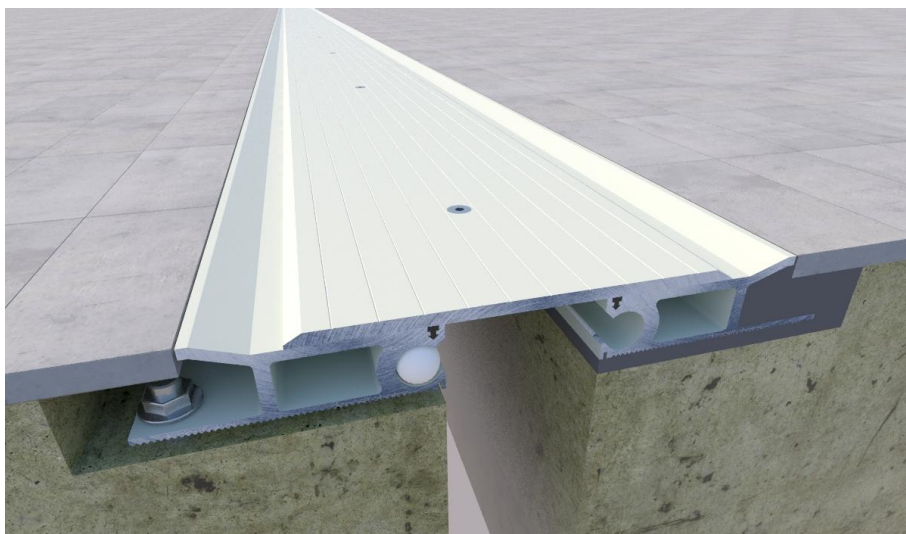

Fx CH

Previous Model No: UAC HD



Multi-directional



Performance

Heavy duty
Concealed Fixings
High Capacity
Low Maintenance

Bead blasted cover plate
Slip resistance Class V
Tested to AS4586 2013

Compatible Finishes

Tiles
Vinyl
Epoxy

Standard Length

4.8m

Standard Finish

Anodised Aluminium

Options



Bead Blasted



| Product | A: Coverplate | | B: Gap | | | | C: Exposed Width | | | Vertical Movement |
|---------|---------------|-------|--------|------|------|-------|------------------|------|------|-------------------|
| | Width | Thick | Min. | Mid. | Max. | Mvmt. | Min. | Mid. | Max. | |
| Fx130CH | 130 | 6 | 6 | 60 | 114 | 108 | 170 | 224 | 278 | ±15 |
| Fx165CH | 165 | 5 | 41 | 95 | 149 | 108 | 205 | 259 | 313 | ±15 |
| Fx220CH | 220 | 6 | 96 | 150 | 204 | 108 | 260 | 314 | 368 | ±15 |
| Fx300CH | 300 | 6 | 176 | 230 | 284 | 108 | 340 | 394 | 448 | ±15 |

Block Out: 120D x 40E

Disclaimer: All design rights reserved. Design and specifications are subject to change without notice. The manufacturer does not accept liability where the material on these pages is misconceived, exploited, or lacks conformity. The intention of this information is to provide a reasonable description of products, procedures and capabilities. Rev.5

Flexo CHT Coverplate EJs

Flexo CHT: A heavy duty architectural floor coverplate system designed for use with heavy pedestrian, and infrequent service-equipment traffic in a deep floor finish. Suitable for use in concourse areas such as stadiums, convention centres, airport terminals. FxCHT can be supplied with coverplates finished in natural and colour anodised aluminium, or bead-blasted.

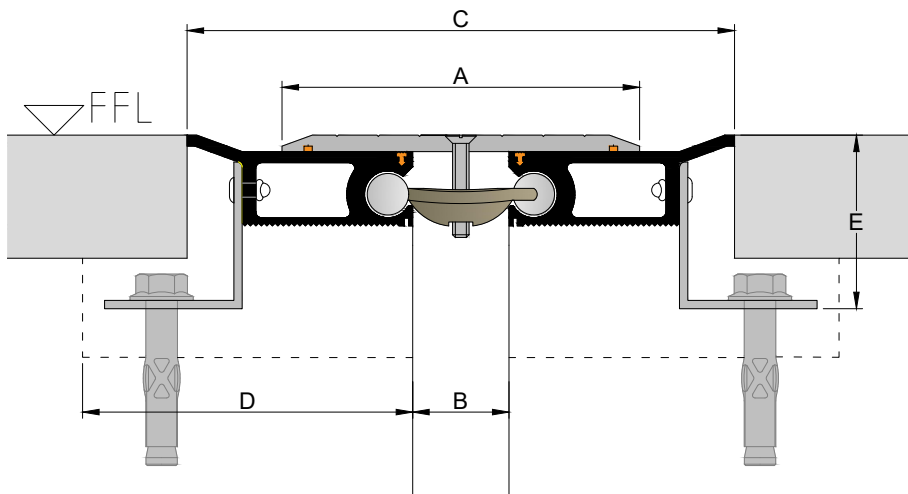
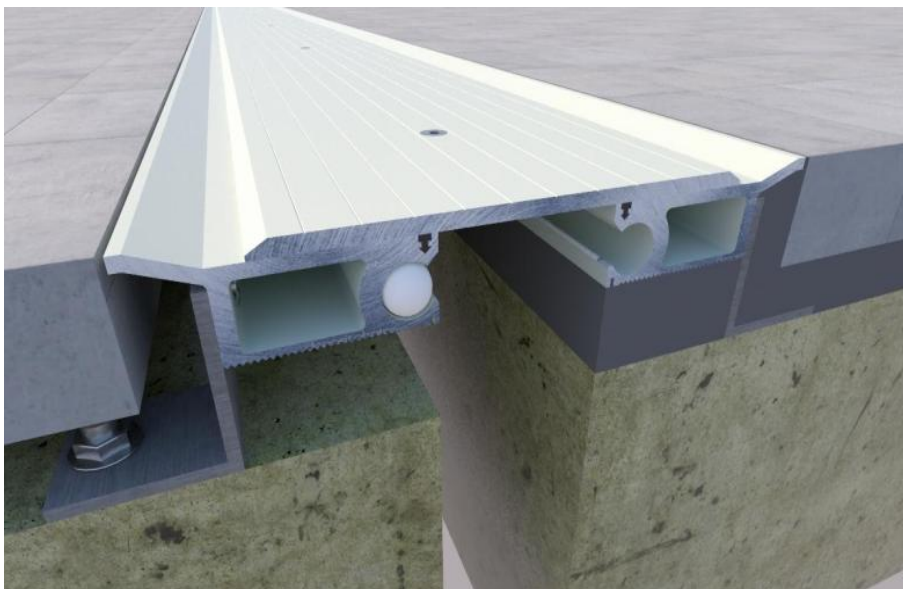

| Product | A: Coverplate | | B: Gap | | | | C: Exposed Width | | | Vertical Movement | E: Depth |
|-----------------|---------------|-------|--------|------|------|-------|------------------|------|------|-------------------|----------|
| | Width | Thick | Min. | Mid. | Max. | Mvmt. | Min. | Mid. | Max. | | |
| Fx130CHT Medium | 130 | 6 | 6 | 60 | 114 | 108 | 170 | 224 | 278 | ±15 | 60 |
| Fx130CHT Large | 130 | 6 | 6 | 60 | 114 | 108 | 170 | 224 | 278 | ±15 | 110 |
| Fx165CHT Medium | 165 | 5 | 41 | 95 | 149 | 108 | 205 | 259 | 313 | ±15 | 60 |
| Fx165CHT Large | 165 | 5 | 41 | 95 | 149 | 108 | 205 | 259 | 313 | ±15 | 110 |
| Fx220CHT Medium | 220 | 6 | 96 | 150 | 204 | 108 | 260 | 314 | 368 | ±15 | 60 |
| Fx220CHT Large | 220 | 6 | 96 | 150 | 204 | 108 | 260 | 314 | 368 | ±15 | 110 |
| Fx300CHT Medium | 300 | 6 | 176 | 230 | 284 | 108 | 340 | 394 | 448 | ±15 | 60 |
| Fx300CHT Large | 300 | 6 | 176 | 230 | 284 | 108 | 340 | 394 | 448 | ±15 | 110 |

Block Out: 120D x E



Fx CHT

Previous Model No: UAC HDT



Multi-directional



Performance

Heavy duty
Concealed Fixings
High Capacity
Low Maintenance

Bead blasted cover plate
Slip resistance Class V
Tested to AS4586 2013

Compatible Finishes

Tiles / Paver / Terrazzo
Exposed Aggregate / Stone / Granite

Standard Length

4.8m

Standard Finish

Anodised Aluminium

Options



Disclaimer: All design rights reserved. Design and specifications are subject to change without notice. The manufacturer does not accept liability where the material on these pages is misconceived, exploited, or lacks conformity. The intention of this information is to provide a reasonable description of products, procedures and capabilities. Rev.1